

GET Mobile ID Card Photo Upload Directions

1. Download GET Mobile

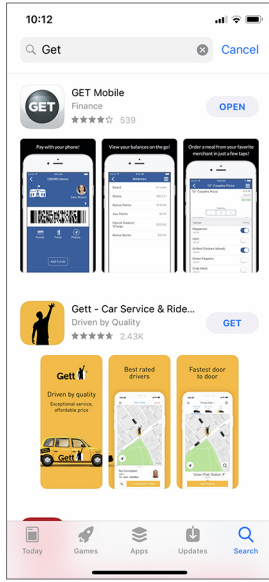

iPhone



Android



2. Select "Azusa Pacific University"

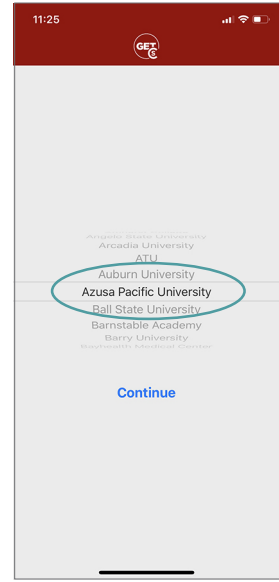

3. Log in with your APU NetID and password

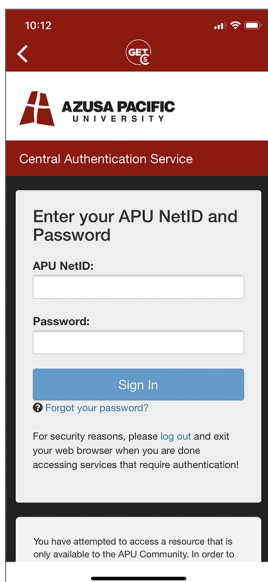

4. Create & verify a pin

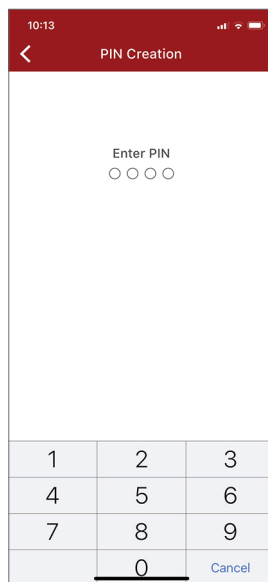

5. Click on "Settings"

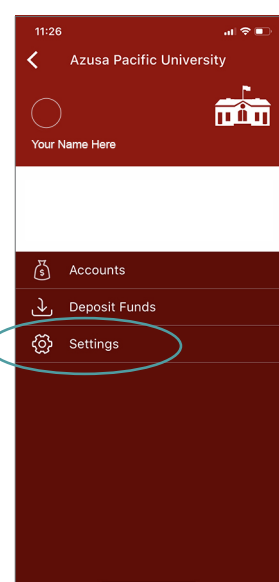



6. Select "Upload Photo"

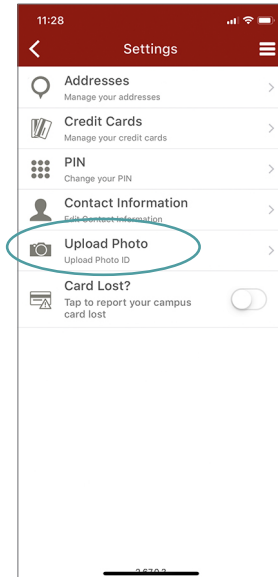

7. Select "Choose Photo" and follow the on-screen instructions to upload a photo from your camera roll or take a photo with your phone's camera.

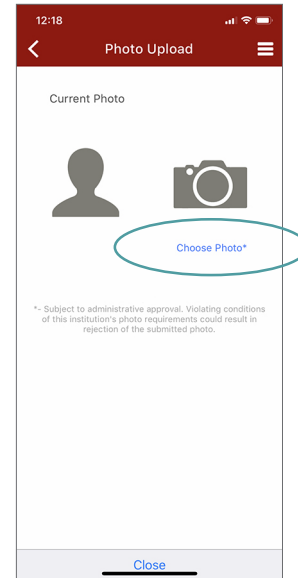

Please adhere to the following guidelines when uploading your ID photo:

- This picture is for identification and must clearly identify you as a person. Treat it as a passport or driver's license photo.
- Take it in front of a plain, light, neutral colored background.
- Photo must be taken within the last 6 months.
- You must be looking straight at the camera. No side profiles or tilting of your head.
- No filters! (This includes Instagram and Snapchat filters.)
- No hats, sunglasses, jewelry or garments of any sort that obstruct the view of your face.
- Wear appropriate clothing.
- Photo must be of only you, no other people can be in the photo.

Photos will be evaluated by the One Card Office and accepted or returned with cause within 24 business hours. You will receive an email when your ID card is ready for pickup at the One Card Office.